

1 January 11, 1979

Introduced by: ROBERT B. DUNN  
Proposed Ordinance No.: 78-247

2  
3  
4  
5 ORDINANCE NO. 4041

6 AN ORDINANCE amending King County Zoning Resolution  
7 No. 25789, as amended, by amending the Zoning Map  
8 thereof reclassifying certain property thereon at  
the request of James H. & Ellen M. Gamrath, et al,  
Building and Land Development Division File No.  
238-78-R.

9 BE IT ORDAINED BY THE COUNCIL OF KING COUNTY:

10 SECTION 1. James H. and Ellen M. Gamrath, et al petitioned  
11 on January 25, 1978, that the property described in Section 3 below  
12 be reclassified from SR to RM 1800 and this application was assign-  
13 ed Building and Land Development Division File No. 238-78-R.

14 SECTION 2. The report and recommendation of the Building and  
15 Land Development Division was transmitted to the Zoning and Sub-  
16 division Examiner on April 20, 1978, and hearing was held by the  
17 Examiner on the matter April 27, 1978. The report of the Examiner  
18 was filed with the Clerk of the King County Council on July 7,  
19 1978, and the Council approved the reclassification by Motion No.  
20 03634 on July 31, 1978, subject to conditions which will be satis-  
21 fied per the "P" suffix.

22 SECTION 3. The legal description of the property to be re-  
23 classified is attached as Appendix A and is hereby made a part of  
24 this ordinance. The above described property is shown on the at-  
25 tached map which is designated Appendix B and is hereby made a part  
26 of this ordinance.

27 SECTION 4. The King County Council does hereby amend King  
28 County Zoning Code, Resolution No. 25789, as amended, by reclassi-  
29 fying that property described and shown in Section 3, Appendices  
30  
31

1 A and B above, to RM 1800-P and directs that Area Map E 24 & 25-21-  
2 3 be modified to so designate.

3 SECTION 5. This reclassification is granted subject to con-  
4 ditions adopted in Motion No. 03634 and said conditions are incor-  
5 porated herein as though fully set forth herein.

6 INTRODUCED AND READ for the first time this 27th  
7 day of March, 19 78.

8 PASSED this 22nd day of January, 19 79.

9 KING COUNTY COUNCIL  
10 KING COUNTY, WASHINGTON

11 Ruby Chow  
12 Chairperson

13 ATTEST:  
14 Dorothy M. Quinn DEPUTY  
15 Clerk of the Council

16 APPROVED this \_\_\_\_\_ day of \_\_\_\_\_,  
17 \_\_\_\_\_

19 KING COUNTY EXECUTIVE

20 DEEMED ENACTED WITHOUT  
21 COUNTY EXECUTIVE'S SIGNATURE.

22 DATED: February 1, 1979

FILE NO. 238-78-R  
APPENDIX A

OVERALL LEGAL DESCRIPTION:

That portion of Government Lot 1, Section 25, Township 21 North, Range 3 East, W.M., in King County, Washington, described as follows: Beginning at the northeast corner of said Government Lot; thence west along the north line thereof, 1,115 feet; thence south parallel with the east line of said lot 430 feet; thence east parallel with said north line, 1,115 feet, to the east line of said lot; thence north along said east line 430 feet to the point of beginning EXCEPT the east 30 feet for road conveyed to King County by deed recorded under Auditor's File No. 842339, and EXCEPT the north 115 feet of the east 450.6 feet of said Government Lot 3.

The south 1/2 of the south 1/2 of the southwest 1/4 of the southeast 1/4 of Section 24, Township 21 North, Range 3 East, W.M., of King County, Washington, less the east 30 feet thereof.

Applicant: JAMES H. & ELLEN M. GAMRATH, et al

APPENDIX B

Zone Change: SR to RM 1800-P

STR: E 24 & 25-21-3

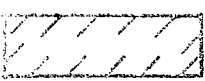

Proposed  
Reclassification

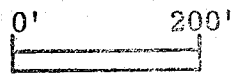

"SEE ATTACHED MAPS"

4001

S-R

S.W. 346<sup>TH</sup> ST.

S-R

S.W. 347<sup>TH</sup> ST. 10' ADD. R/W

20' ADD. R/W

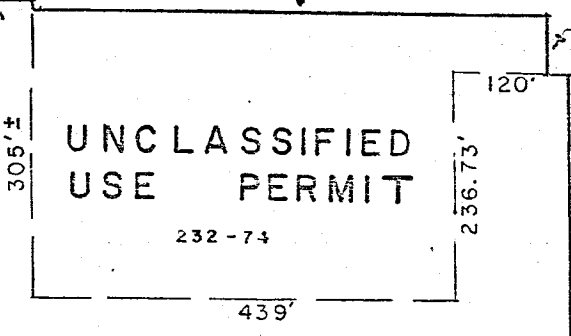

S-R



1" = 200'  
238-78-R  
PAGE 2 OF 3

S.W. 21<sup>ST</sup> AVE.

S-R

S.W. 350<sup>TH</sup> ST

S-R

S.W. 351<sup>ST</sup> ST

S-R

PM-1800-F

24  
25

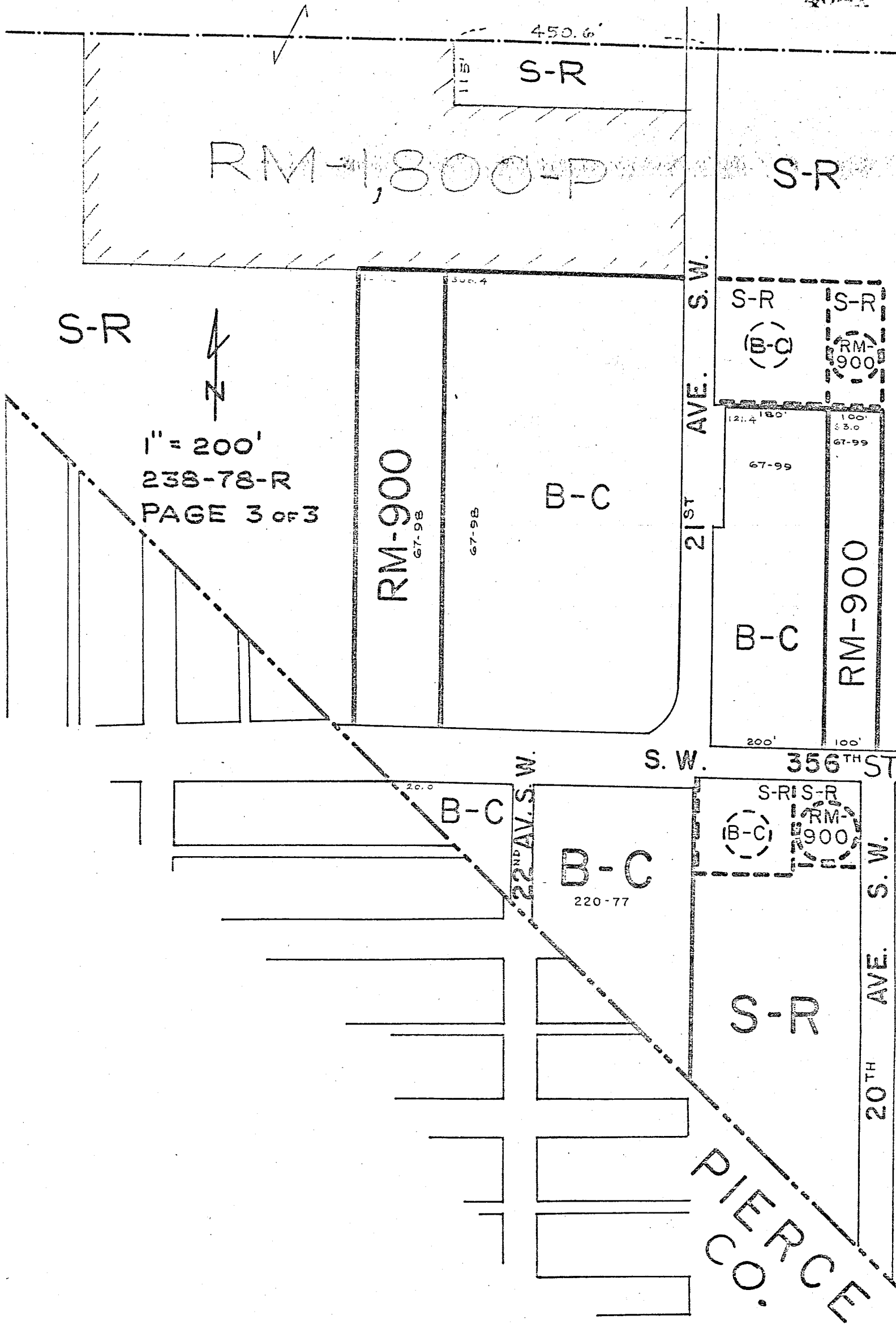

1" = 200'  
 238-78-R  
 PAGE 3 OF 3

PIERCE